

INTERLUBE

Leaders in Lubrication Solutions



RADIAL GREASE SYSTEM Centralised Lubrication System Multi-Industry Applications



Interlube Systems Ltd - maximising industrial performance world-wide...

RADIAL GREASE SYSTEMS

Radial Major and Minor pumps are available for direct drive (parent machine) or as complete motorised/reduction drive assemblies. Lubricant delivery is provided by individual adjustable pumping units located radially around the pump body and actuated by an internal cam.

Each pumping unit is calibrated to permit adjustment during operation. When the optimum delivery rate is established the setting is locked and no further action is necessary.

The Radial Minor has a maximum of 4 pumping units while the Major can accommodate up to 10, 20 or 30 pumping units. Additional points may be covered by distribution blocks. Motorised Radials are available with a choice of geared reduction drives to govern maximum delivery rates and with a range of reservoir capacities.

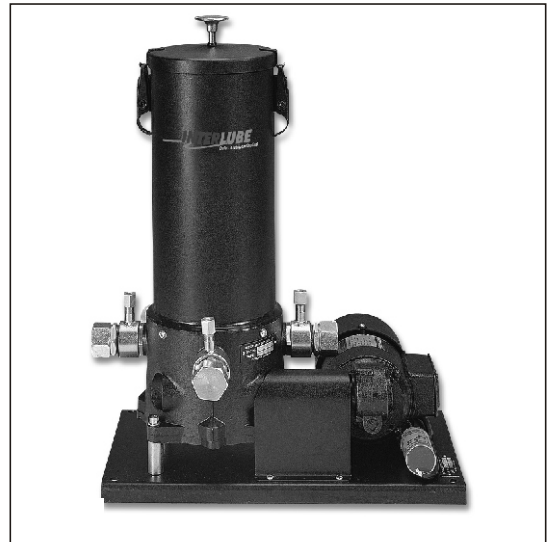

Ideally suited for plant in continuous operation: Steel Works, Cement Works, Rolling Mills, Large Cranes and Sewage Processing.

**DIMENSIONS RADIAL MAJOR
- motorised reduction drive**

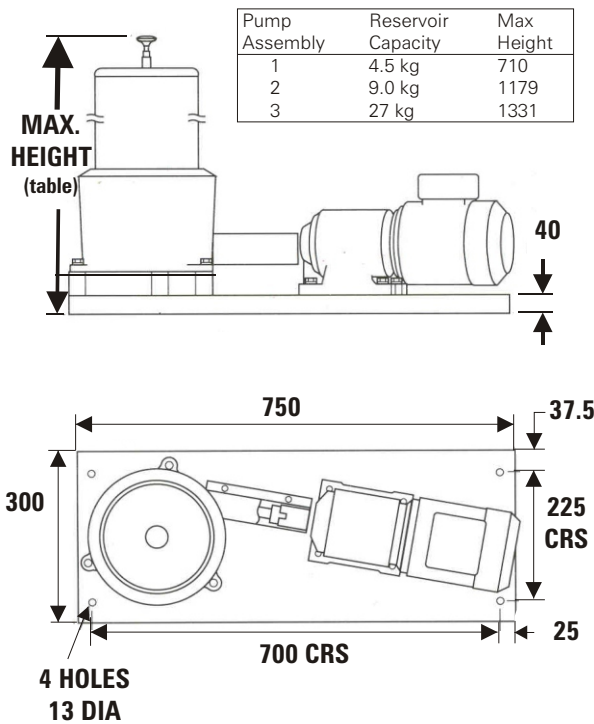

**DIMENSIONS RADIAL MINOR
- motorised reduction drive**

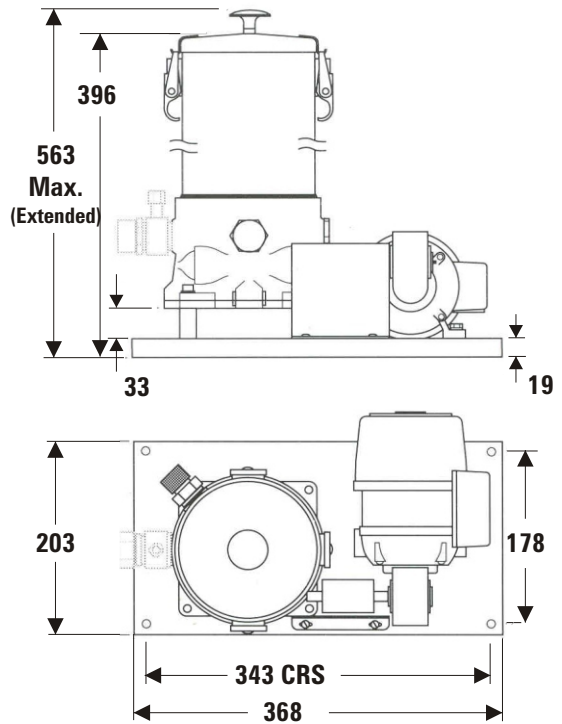

All dimensions are in mm.

RADIAL MAJOR - motorised reduction drive

This assembly comprises a Radial Major lubricator driven by a helical geared electric motor mounted on a base plate. The integral reservoir includes a level indicator and an impeller which ensures that the pumping units remain continually primed.

PERFORMANCE

Delivery per pumping unit per hour

Geared Motor Speed (RPM)	MIN	MAX
36	0.5 cc	13 cc
57	0.8 cc	21 cc
90	1.3 cc	34 cc
148	2.2 cc	55 cc

Other geared motors are available to special order

PUMPING UNIT

The required output is obtained by rotating a knurled ring and locking it into position with a lock nut. To facilitate adjustment, three grooves are machined in the body indicating maximum, two thirds and one third output. Full clockwise rotation reduces output to the minimum value of 0.02cc per stroke.

SPECIFICATION

Delivery per stroke:	0.02 - 0.5cc		
Max pressure:	100 Bar (1450 psi)		
Outlet Connection:	3/8 in OD (Metric available)		
Lubricants:	Heavy oil and NLGI Grade 2 greases. For Grade 3 grease applications please consult Interlube.		
Pumping Unit:	Part No.	67688	Unused outlets
Blanking Plug:	Part No.	106050	
Sealing Washer:	Part No.	28280	

ORDERING METHOD

Radial major motorised assemblies are ordered by compiling a simple matrix from the following information:

MR <input type="checkbox"/> <input type="checkbox"/> <input type="checkbox"/> <input type="checkbox"/>			
PUMP ASSEMBLY	RESERVOIR CAPACITY	GEARED MOTOR SPEED	VOLTAGE
1 Up to 10 pumping units	1 4.5 kg	4 36 rpm	*1 110V 1ph 50Hz
2 Up to 20 pumping units	2 9.0 kg	5 57 rpm	*2 220V 1ph 50Hz
3 Up to 30 pumping units	3 27 kg	6 90 rpm	7 380/440V 3ph 50Hz
		7 148 rpm	

* Not available for 36 rpm assemblies: other voltage available on request.

* Note: Radial Major pumping units, blanking plugs and sealing washers are ordered and supplied separately.

Example: Mr2252 is a 20 unit assembly fitted with a 9 kg reservoir. The geared motor speed is 57 rpm powered by a 220v 1 ph 50 Hz electric motor.

RADIAL MINOR - motorised reduction drive

This assembly comprises a Radial Minor lubricator driven by an electric motor and mounted on a base plate. The integral reservoir includes a level indicator and an impeller which ensures that the pumping units remain continually primed.

PERFORMANCE

Delivery per pumping unit per hour

Geared Motor Speed (RPM)	MIN	MAX
39	Adjustable	9.36 cc
56	to	13.44 cc
97	Zero	23.28 cc
150		36 cc

Other geared motors are available to special order

PUMPING UNIT

Output is controlled by rotating a spring loaded adjuster screw clockwise to increase and anti-clockwise to decrease. The adjuster screw is then secured by a lock nut.

SPECIFICATION

Delivery per stroke:	0 - 0.2cc		
Max pressure:	70 Bar (1015 psi)		
Max No. of Pumping Units:	4		
Reservoir Capacity:	3kg		
Outlet Connection:	1/4 in OD (Metric available)		
Lubricants:	Heavy oil and NLGI Grade 2 greases. For Grade 3 grease applications please consult Interlube.		
Pumping Unit:	Part No.	67801	Unused outlets
Blanking Plug:	Part No.	34232-207	

ORDERING METHOD

Catalogue No.	GEARBOX rpm	Voltage
AF1501	150	
AF1502	97	100/110V 1ph 50Hz
AF1503	56	(0.5 Amp. - 30 Watts)
AF1504	39	
AF1507	150	
AF1508	97	200/220V 1ph 50Hz
AF1509	56	(0.3 Amp. - 30 Watts)
AF1510	39	
AF1513	150	
AF1514	97	230/250V 1ph 50Hz
AF1515	56	(0.25 Amp. - 30 Watts)
AF1516	39	
AF1519	150	
AF1520	97	380/440V 3ph 50Hz
AF1521	56	(0.15 Amp. - 30 Watts)
AF1522	39	

NB: Radial Minor Pumping units and plugs for unwanted outlets are ordered and supplied separately.

Example: AF1514 is fitted with a 97 rpm gearbox and a 230/250V 1ph 50 Hz electric motor.

**RADIAL MAJOR - Direct Rotary Drive
(from parent machine)**

TECHNICAL SPECIFICATION

Max Drive Shaft Speed	1000 rpm
Min Drive Shaft Speed	10 rpm
Internal Reduction Ratio	80 : 1
Max No. of Pumping Units	30
Reservoir Capacity	4.5 kg
	9 kg
	27 kg
Lubricants	Heavy oil and NLGI grade 2 greases.

For grade 3 grease applications, please consult Interlube.

NB: Radial Major pumping units, blanking plugs and sealing washers are ordered and supplied separately.

**RADIAL MINOR - Direct Rotary Drive
(from parent machine)**

TECHNICAL SPECIFICATION

Max Drive Shaft Speed	500 rpm
Min Drive Shaft Speed	25 rpm
Internal Reduction Ratio	50 : 1
Max No. of Pumping Units	4
Reservoir Capacity	3 kg
Lubricants	Heavy oil and NLGI grade 2 greases.

For grade 3 grease applications, please consult Interlube.

NB: Radial Minor pumping units and their blanking plugs are ordered and supplied separately.

RADIAL MAJOR

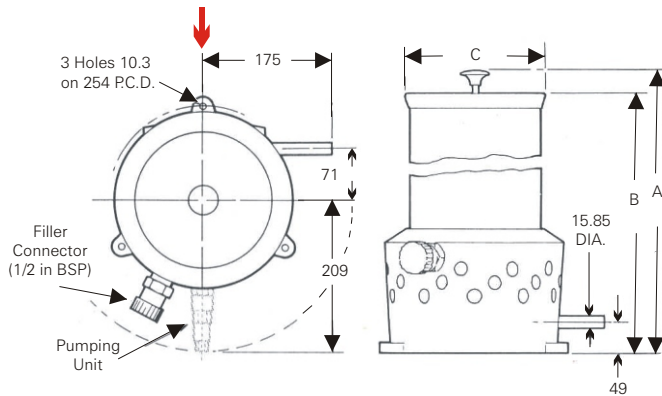

ORDERING METHOD

Prefix	<u>AFA</u>	<u>AFB</u>	<u>AFC</u>
Reservoir Capacity	4.5 kg	9 kg	27 kg

<u>No. of Outlets - Catalogue Number</u>		
10 - 1448	20 - 1449	30 - 1450

TABLE OF DIMENSIONS

Type	'A'	'B'	'C'
AFA	629	438	187
AFB	1098	641	187
AFC	1251	730	259

Note: all dimensions are in mm

RADIAL MINOR

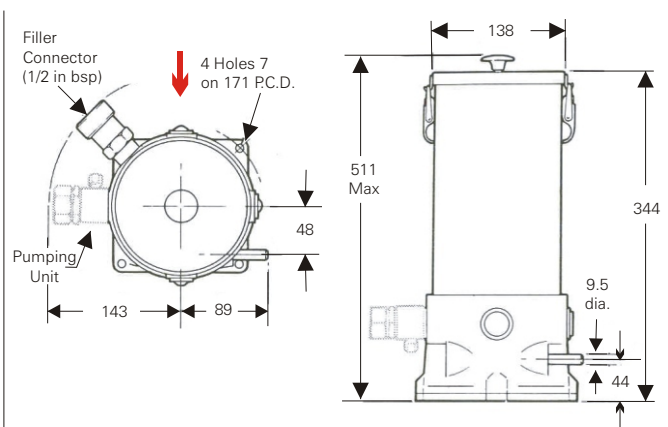

DIRECTION OF DRIVE

LH drive as viewed from the arrow is supplied as standard, RH drive is available to special order.



Interlube Systems Ltd
 St Modwen Road, Parkway Industrial Estate
 Plymouth, Devon, England PL6 8LH
 Tel: +44 (0)1752 676000
 Fax: +44 (0)1752 676001
 e-mail: info@interlubesystems.com
 Web Site: www.interlubesystems.com

The Company reserves the right to amend any design or specification without prior notice